

LOWER LEVEL MEETING SPACE

UPPER LEVEL MEETING SPACE

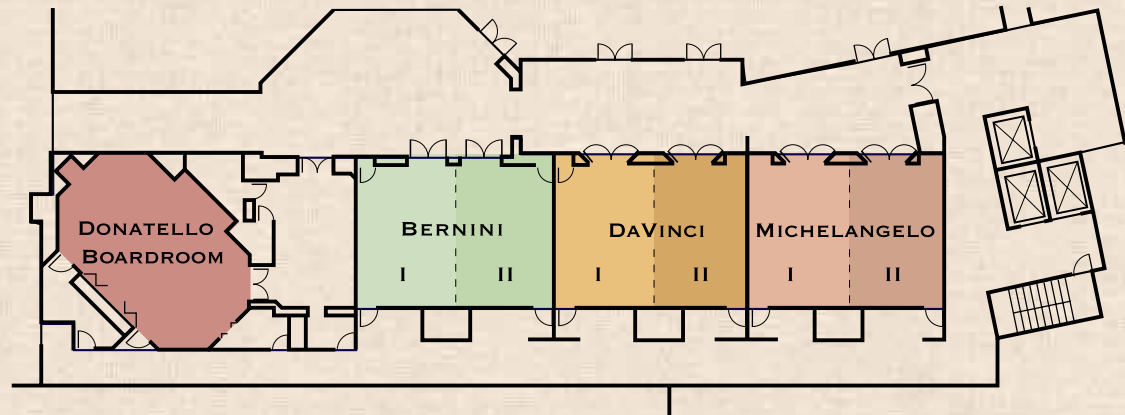

LOWER LEVEL MEETING SPACE

NAME	SQUARE FOOTAGE	DIMENSIONS	CEILING HGT. MINIMUM/MAXIMUM	CAPACITIES			
				THEATRE	SCHOOL ROOM	BANQUET (ROUNDS OF 12)	CONFERENCE
TUSCAN BALLROOM	15,040	160'x94'	22'0"/27'0"	1,380	940	1,248	
TUSCAN I	2,256	48'x47'		240	126	192	
TUSCAN II	2,256	48'x47'		240	126	192	
TUSCAN III	6,016	64'x94'		660	432	480	
TUSCAN IV	4,512	48'x94'		520	252	384	
LIGURIAN <sup>SM</sup>	2,967	43'x69'	14'0"	374	185	288	
LIGURIAN I	946	22'x43'		120	60	96	41
LIGURIAN II	946	22'x43'		120	60	96	41
LIGURIAN III	946	22'x43'		120	60	96	41
VICENZA <sup>SM</sup>	646	34'x19'	14'8"/16'0"	60	40	60	28
VICENZA I	300			30	18	24	14
VICENZA II	300			30	18	24	14
VERONA	646	34'x19'	14'8"/16'0"	60	40	60	28
VERONA I	300			30	18	24	14
VERONA II	300			30	18	24	14
VENETIAN BALLROOM	7,670	118'x65'	16'0"/20'0"	780	538	600	
VENETIAN I	928	29'x32'		110	50	48	30
VENETIAN II	928	29'x32'		110	50	48	30
VENETIAN III	1,885	29'x65'		170	144	144	83
VENETIAN IV	1,885	29'x65'		170	144	144	83
VENETIAN V	1,950	30'x65'		170	144	168	86

Capacity figures do not account for head tables, dance floors or audiovisual requirements. Rear screen projection may require additional space.

UPPER LEVEL MEETING SPACE

NAME	SQUARE FOOTAGE	DIMENSIONS	CEILING HGT. MINIMUM/MAXIMUM	CAPACITIES			
				THEATRE	SCHOOL ROOM	BANQUET (ROUNDS OF 12)	CONFERENCE
DONATELLO BOARDROOM	1,990		12'0"/14'0"	-	-	-	-
<i>*Permanent Boardroom table</i>							
BERNINI	850	25'x34'	14'0"	96	52	60	34
BERNINI I	425			40	24	24	20
BERNINI II	425			40	24	24	20
DAVINCI <sup>SM</sup>	850	25'x34'	14'0"	96	52	60	34
DAVINCI I	425			40	24	24	20
DAVINCI II	425			40	24	24	20
MICHELANGELO	850	25'x34'	14'0"	96	52	60	34
MICHELANGELO I	425			40	24	24	20
MICHELANGELO II	425			40	24	24	20
HOSPITALITY SUITES (6)	903*						
<i>*Rectangular open space of Hospitality parlor not including foyer and pantry area (43'x21').</i>							
DELMARE	851	23'x37'	8'	60	40	48	28
MULTIPLE OUTDOOR FUNCTION AREAS AVAILABLE — 3,000 – 30,000 SQUARE FEET							

Capacity figures do not account for head tables, dance floors or audiovisual requirements.