

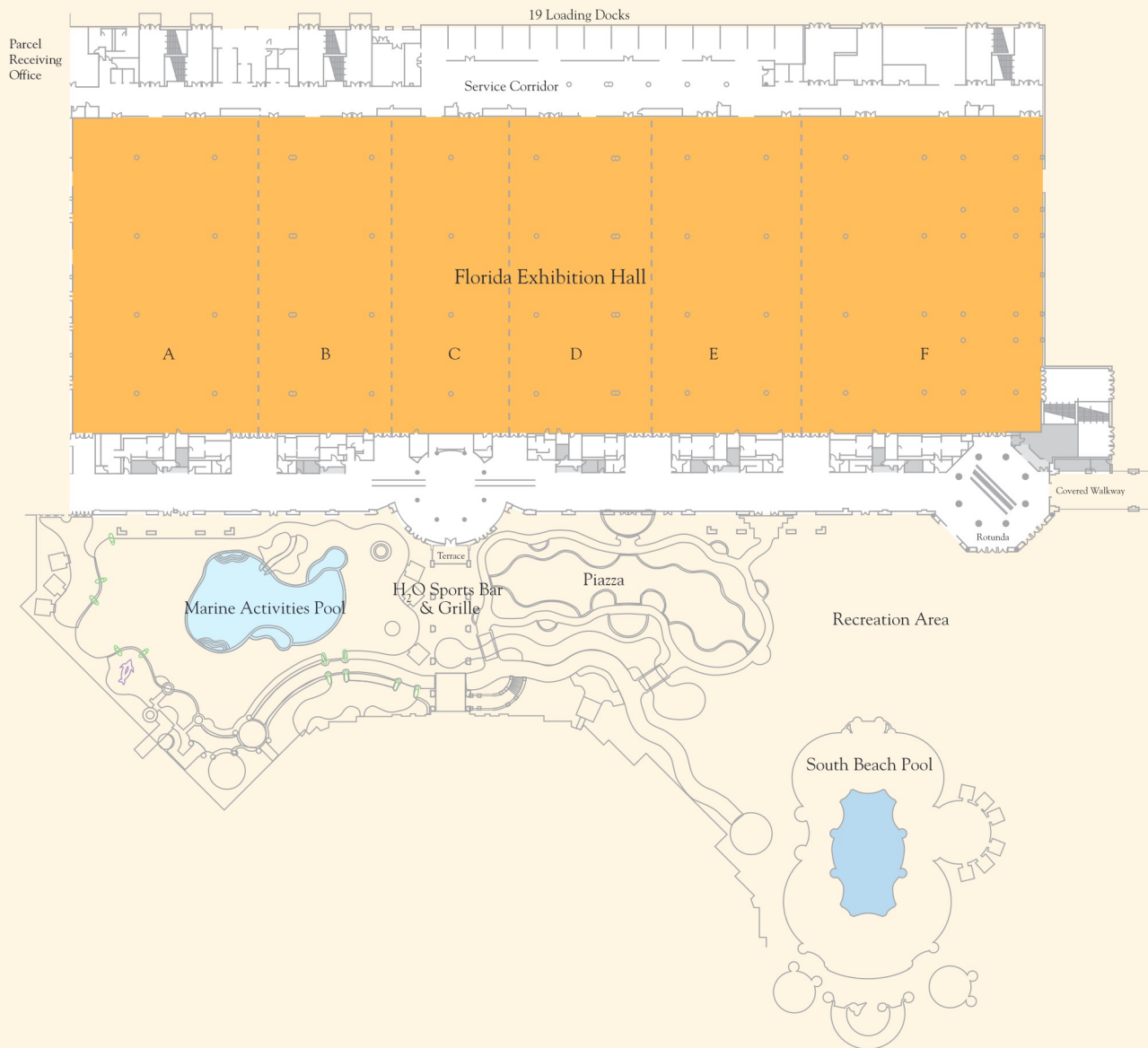

GAYLORD PALMS EXHIBITION HALL



ROOM	TOTAL SQ. FT.	8 x 10 BOOTHS	10 x 10 BOOTHS	THEATER	BANQUET	RECEPTION	CLASSROOM	MODULAR BREAKOUTS	WIDTH	LENGTH	CEILING HT.
FLORIDA EXHIBITION HALL											
TOTAL	178,500	1,116	893	21,326	11,928	14,770	12,792	173	740'	241'	24'
SECTION A	34,300	214	172	4,276	2,328	2,860	2,568	34	142'	241'	24'
SECTION B	24,570	154	123	2,725	1,620	2,020	1,653	23	102'	241'	24'
SECTION C	21,700	136	109	2,746	1,400	1,850	1,419	22	90'	241'	24'
SECTION D	24,570	154	123	2,725	1,620	2,020	1,653	23	102'	241'	24'
SECTION E	29,000	181	145	3,444	1,972	2,440	2,181	28	120'	241'	24'
SECTION F	44,360	277	222	5,410	2,988	3,580	3,318	43	184'	241'	24'
PRE-FUNCTION SPACE	31,800										
9 OFFICES (LOCKABLE)				RANGE 160–200 SQ. FT.							
5 REGISTRATION DESKS (LOCKABLE)				APPROX. 80 SQ. FT.							
BELLDISK	LUGGAGE STORAGE			VALET PARKING							

Capacities shown are maximum for each room, with no staging or audio-visual, and should be used for reference only. Room capacities will be diminished based on your staging and audio-visual needs.



GAYLORD PALMS BALLROOM LEVEL

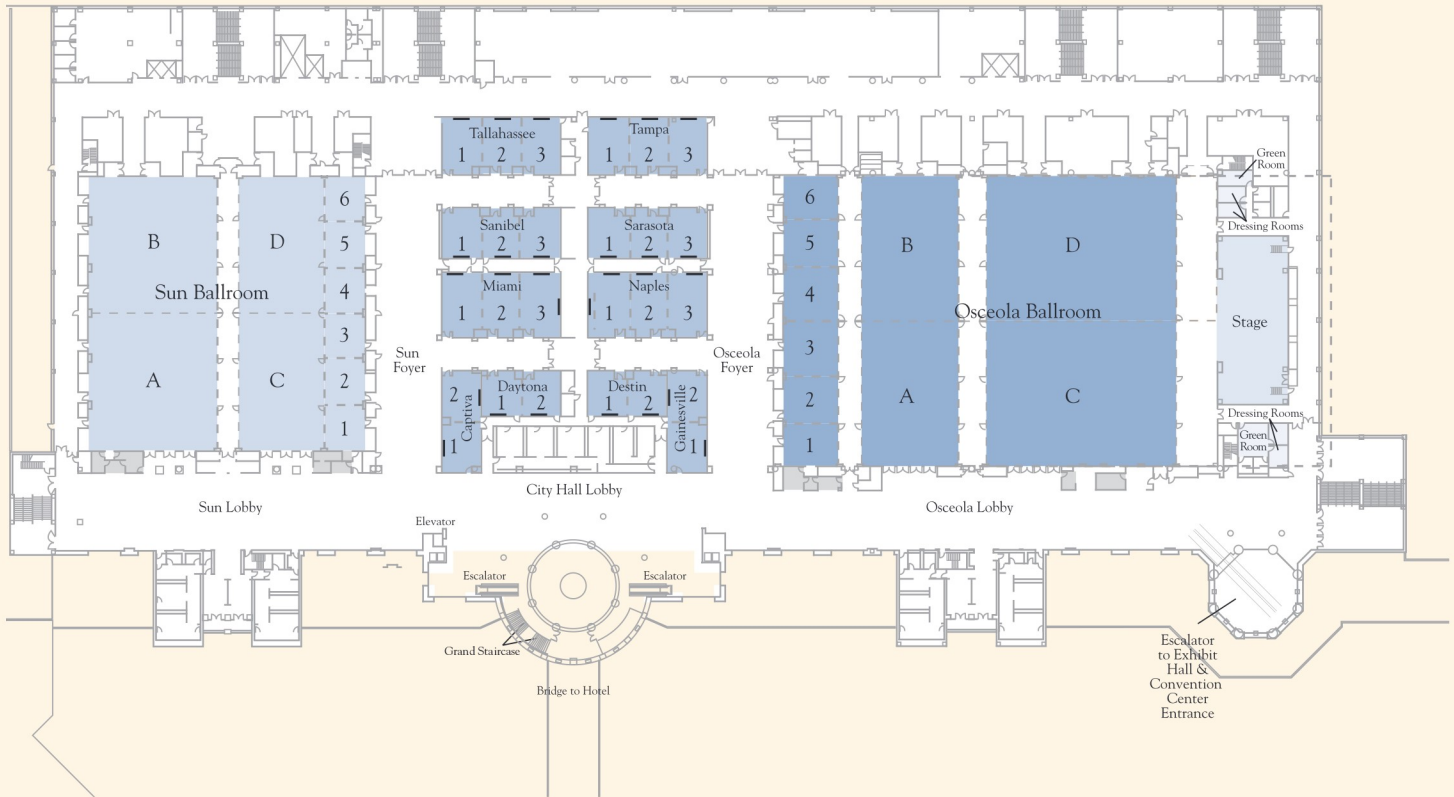

MEETING ROOM	TOTAL SQ. FT.	THEATER	BANQUET	CLASSROOM	CONF/HOLLOW SQ.	U CONFERENCE	RECEPTION	WIDTH	LENGTH	CEILING HT.
BALLROOM LEVEL										
SUN	29,014	3,040	1,960	1,860			2,520	179'	187'	24'
A	6,682	665	490	450			580	84'	89'	24'
B	6,863	665	490	450			595	84'	98'	24'
C	4,350	418	280	285			375	52'	89'	24'
D	4,556	418	280	285			395	52'	98'	24'
AB/CD CORRIDOR	2,127							13'	187'	24'
BREAKOUT 1	767	70	40	34	34	28	65	30'	33'	24'
BREAKOUT 2	762	72	40	45	34	26	65	30'	29'	24'
BREAKOUT 3	663	71	40	45	34	26	55	27'	27'	24'
BREAKOUT 4	667	71	40	45	34	26	60	27'	27'	24'
BREAKOUT 5	768	73	40	45	34	26	65	30'	29'	24'
BREAKOUT 6	809	69	40	34	34	28	70	30'	42'	24'

Capacities shown are maximum for each room, with no staging or audio-visual, and should be used for reference only. Room capacities will be diminished based on your staging and audio-visual needs.